

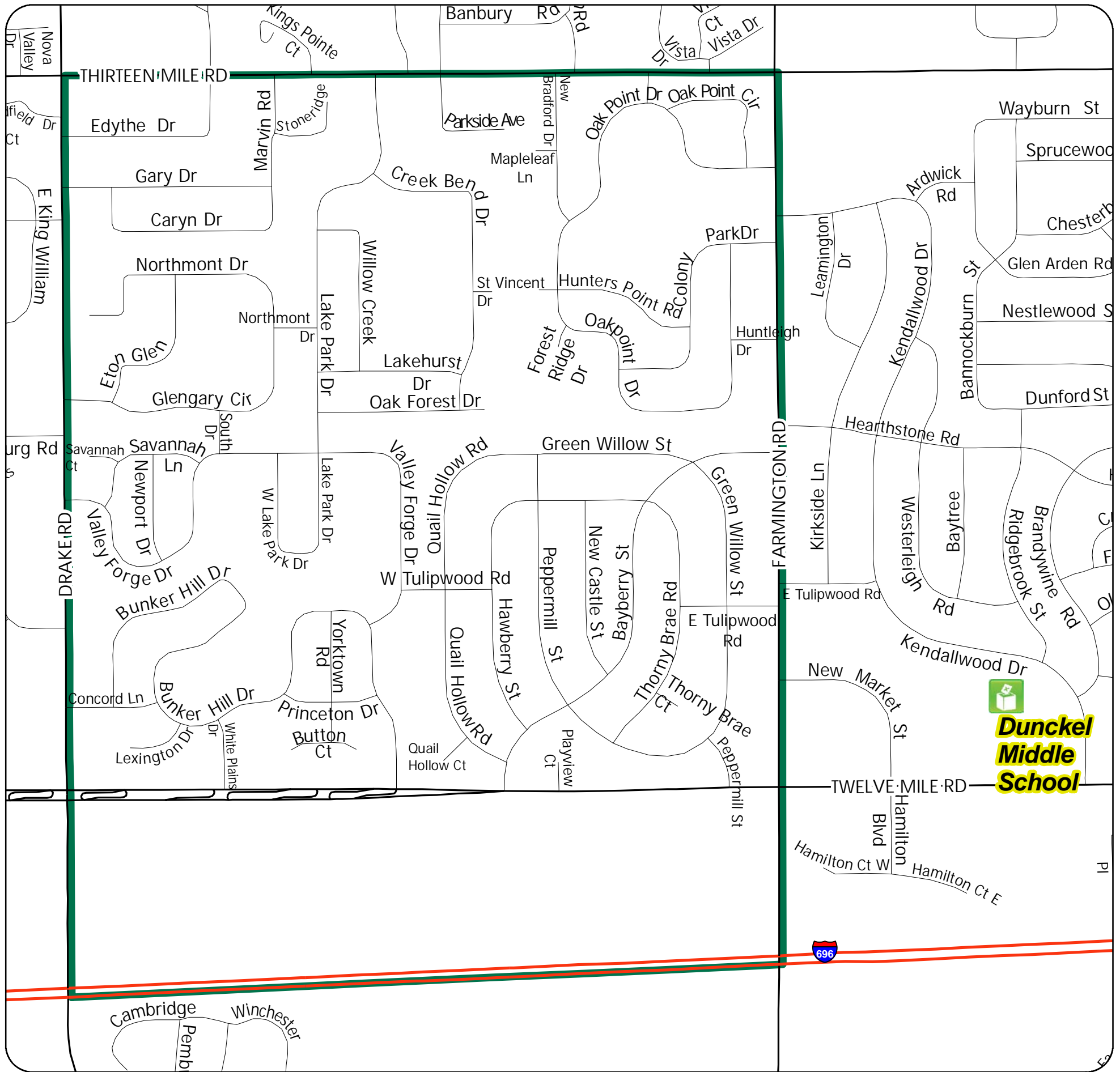

Voting Precinct 9

City of Farmington Hills, Michigan



PRECINCT STREETS

- | | |
|-------------------------|-----------------|
| W 12 MILE RD (Portion) | NEW CASTLE RD |
| W 13 MILE RD (Portion) | NEWPORT ST |
| BAYBERRY RD | NORTHMONT DR |
| BUNKER HILL DR | OAK FOREST DR |
| BUTTON CT | OAK POINT DR |
| CARYN ST | OAK POINT CIR |
| COLONY PARK DR | PARKSIDE ST |
| CONCORD LN | PEPPERMILL RD |
| CREEK BEND DR | PLAYVIEW CT |
| DRAKE RD (Portion) | PRINCETON ST |
| EDYTHE DR | QUAIL HOLLOW CT |
| ETON GLN | QUAIL HOLLOW RD |
| FARMINGTON RD (Portion) | SAVANNAH CT |
| FOREST RIDGE DR | SAVANNAH LN |
| GARY DR | STONERIDGE CT |
| GLENGARY CIR | THORNY BRAE RD |
| GREEN WILLOW ST | THORNY BRAE CT |
| HAWBERRY RD | VALLEY FORGE DR |
| HUNTERS POINTE RD | WHITE PLNS |
| HUNTLEIGH DR | WILLOW CREEK ST |
| LAKE PARK DR | YORKTOWN ST |
| LAKEHURST DR | |
| LEXINGTON ST | |
| MARVIN RD | |
| NEW BRADFORD DR | |



PRECINCT LOCATIONS

- | | | |
|-------|---|---|
| Pct # | 1 | WARNER MIDDLE SCHOOL, 30303 Fourteen Mile Rd
Between Northwestern Hwy and Middlebelt Rds |
| 2 | ORCHARD UNITED METHODIST CHURCH, 30450 Farmington Rd
Between 13 & 14 Mile Rds | |
| 3 | FOREST ELEMENTARY SCHOOL, 34545 Old Timber Rd
Between Farmington and Drake, between 13 & 14 Mile Rds | |
| 4 | FAITH COVENANT CHURCH, 35415 Fourteen Mile Rd
Southwest corner of Drake Rd | |
| 5 | GRACE CHAPEL CHURCH, 27996 Halsted Road
Just north of 12 Mile Rd | |
| 6 | GRACE CHAPEL CHURCH, 27996 Halsted Road
Just north of 12 Mile Rd | |
| 7 | HOPE LUTHERAN CHURCH, 39200 Twelve Mile Rd
Between Halsted and Haggerty Rds | |
| 8 | NORTH CONGREGATIONAL CHURCH, 36520 Twelve Mile Rd
Between Drake and Halsted Roads | |
| 9 | DUNCKEL MIDDLE SCHOOL, 32800 Twelve Mile Rd
Between Orchard Lake and Farmington Rds | |
| 10 | KENBROOK ELEMENTARY SCHOOL, 32130 Bonnet Hill Rd
Between 12 & 13 Mile Rds, between Orchard Lake and Farmington Rds | |
| 11 | HIGHMEADOW COMMON CAMPUS, 30175 Highmeadow,
Between Orchard Lake and Middlebelt, between 12 & 13 Mile Rds | |
| 12 | WOODCREEK ELEMENTARY SCHOOL, 28400 Harwich,
North of 12 Mile Rd, between Inkster and Middlebelt | |
| 13 | FARMINGTON HILLS ACTIVITIES CENTER, 28600 Eleven Mile Rd
Between Middlebelt and Inkster | |
| 14 | FIRST PRESBYTERIAN CHURCH, 26165 Farmington Rd
Northwest corner of Eleven Mile Rd | |
| 15 | ST TOMA SYRIAC CATHOLIC CHURCH, 25600 Drake Rd
Corner of Drake and Eleven Mile Rd | |
| 16 | HILLSIDE ELEMENTARY SCHOOL, 36801 Eleven Mile Rd
Between Drake and Halsted | |
| 17 | ST TOMA SYRIAC CATHOLIC CHURCH, 25600 Drake Rd
Corner of Drake and Eleven Mile Rd | |
| 18 | EAST MIDDLE SCHOOL, 25000 Middlebelt
Between 10 & 11 Mile Rds | |
| 19 | EAST MIDDLE SCHOOL, 25000 Middlebelt
Between 10 & 11 Mile Rds | |
| 20 | SALVATION ARMY COMMUNITY CENTER, 27500 Shiawassee
Corner of Shiawassee and Inkster Rds | |
| 21 | LANIGAN ELEMENTARY SCHOOL, 23800 Tuck Road
South of 10 Mile Rd, between Orchard Lake and Middlebelt | |
| 22 | BETHLEHEM EVANGELICAL LUTHERAN CHURCH, 35300 Eight Mile Rd
West of Gill Rd | |
| 23 | BETHLEHEM EVANGELICAL LUTHERAN CHURCH, 35300 Eight Mile Rd
West of Gill Rd | |
| 24 | POWER MIDDLE SCHOOL, 34740 Rhonswood
West of Gill Rd | |
| 25 | GILL ELEMENTARY SCHOOL, 21195 Gill Rd
Between 8 & 9 Mile Rds, west of Farmington Rd | |
| 26 | FARMINGTON COMMUNITY SCHOOL, 30415 Shiawassee
Corner of Shiawassee and Tuck Rds | |
| 27 | ST ALEXANDER'S CHURCH, 27835 Shiawassee
Between Middlebelt and Inkster Rds | |

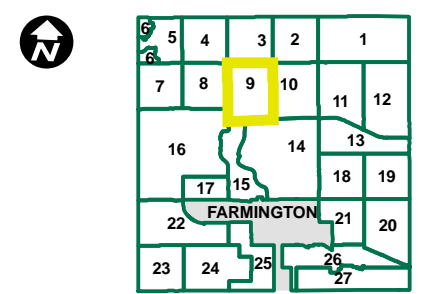
PRECINCT MAP



MAP LEGEND

-  Voting Location
-  Voting Precinct Boundary



DISCLAIMER: Although the information provided by this map is believed to be reliable, its accuracy is not warranted in any way. The City of Farmington Hills assumes no liability for any claims arising from the use of this map.

SOURCES: City of Farmington Hills GIS, 2010
City Clerk's Office, 2010
Oakland County GIS, 2010