

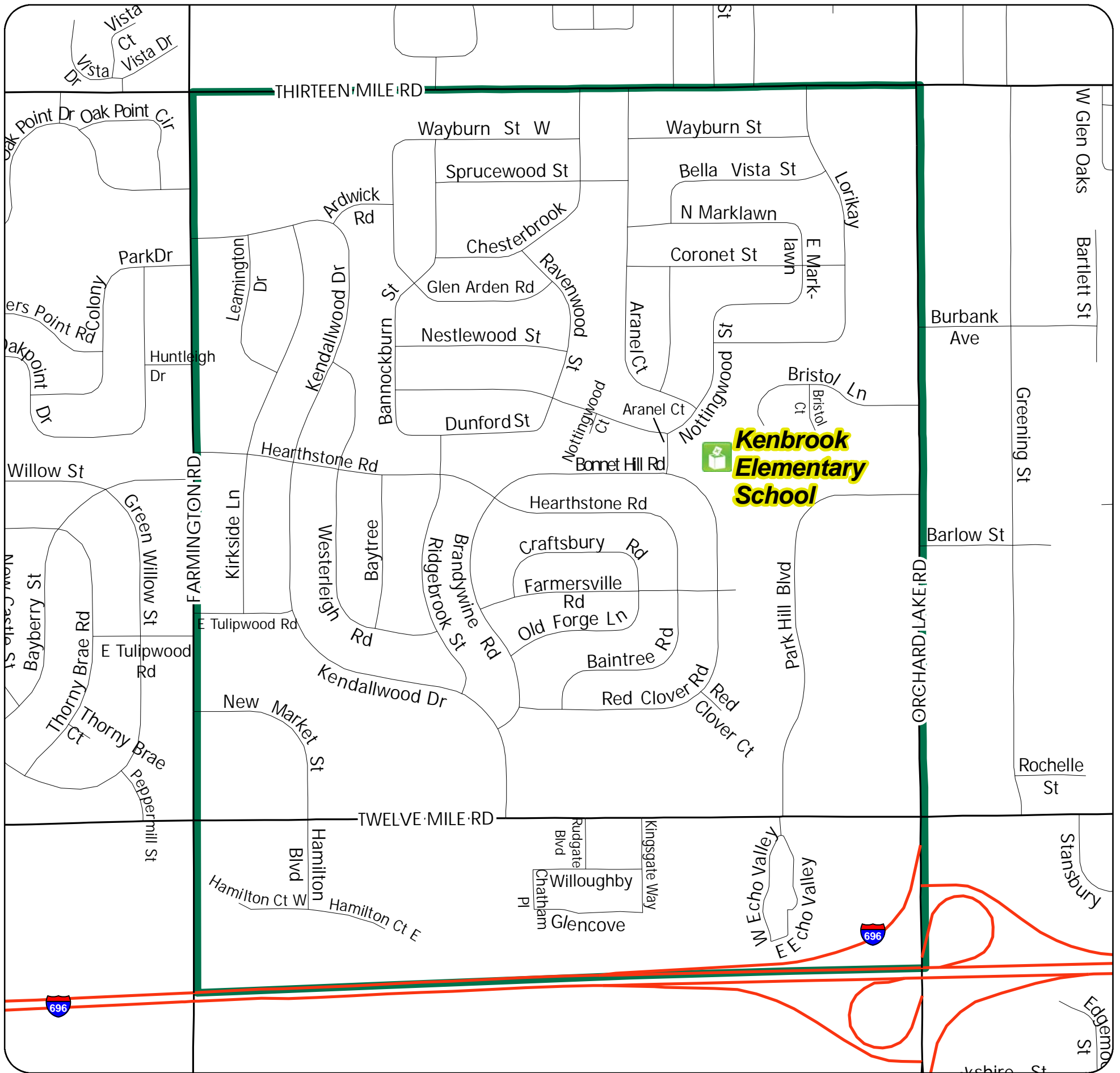

Voting Precinct 10

City of Farmington Hills, Michigan



PRECINCT STREETS

- | | |
|-------------------------|-----------------|
| W 12 MILE RD (Portion) | KENDALLWOOD DR |
| W 13 MILE RD (Portion) | KINGSGATE WAY |
| ARANEL ST | KIRKSIDE LN |
| ARDWICK RD | LEAMINGTON DR |
| BAINTREE RD | LORIKAY ST |
| BANNOCKBURN ST | N MARKLAWN ST |
| BAY TREE RD | E MARKLAWN ST |
| BELLA VISTA DR | NESTLEWOOD ST |
| BONNET HILL RD | NEW MARKET RD |
| BRANDYWINE RD | NOTTINGWOOD CT |
| BRISTOL CT | NOTTINGWOOD ST |
| BRISTOL LN | OLD FORGE LN |
| CHATHAM PL | ORCHARD LAKE RD |
| CHESTERBROOK ST | PARKHILL ST |
| CORONET DR | RAVENWOOD ST |
| CRAFTSBURY RD | RED CLOVER CT |
| DUNFORD ST | RED CLOVER RD |
| E ECHO VLY | RIDGEBROOK RD |
| W ECHO VLY | RUDGATE BLVD |
| FARMERSVILLE RD | SPRUCEWOOD ST |
| FARMINGTON RD (Portion) | TULIPWOOD RD |
| GLEN CV | W WAYBURN ST |
| GLENARDEN ST | WAYBURN ST |
| HAMILTON CT | WESTERLEIGH RD |
| HEARTHSTONE RD | WILLOUGHBY RD |

PRECINCT LOCATIONS

- | | | |
|-------|---|---|
| Pct # | 1 | WARNER MIDDLE SCHOOL, 30303 Fourteen Mile Rd
Between Northwestern Hwy and Middlebelt Rds |
| 2 | ORCHARD UNITED METHODIST CHURCH, 30450 Farmington Rd
Between 13 & 14 Mile Rds | |
| 3 | FOREST ELEMENTARY SCHOOL, 34545 Old Timber Rd
Between Farmington and Drake, between 13 & 14 Mile Rds | |
| 4 | FAITH COVENANT CHURCH, 35415 Fourteen Mile Rd
Southwest corner of Drake Rd | |
| 5 | GRACE CHAPEL CHURCH, 27996 Halsted Road
Just north of 12 Mile Rd | |
| 6 | GRACE CHAPEL CHURCH, 27996 Halsted Road
Just north of 12 Mile Rd | |
| 7 | HOPE LUTHERAN CHURCH, 39200 Twelve Mile Rd
Between Halsted and Haggerty Rds | |
| 8 | NORTH CONGREGATIONAL CHURCH, 36520 Twelve Mile Rd
Between Drake and Halsted Roads | |
| 9 | DUNCKEL MIDDLE SCHOOL, 32800 Twelve Mile Rd
Between Orchard Lake and Farmington Rds | |
| 10 | KENBROOK ELEMENTARY SCHOOL, 32130 Bonnet Hill Rd
Between 12 & 13 Mile Rds, between Orchard Lake and Farmington Rds | |
| 11 | HIGHMEADOW COMMON CAMPUS, 30175 Highmeadow,
Between Orchard Lake and Middlebelt, between 12 & 13 Mile Rds | |
| 12 | WOODCREEK ELEMENTARY SCHOOL, 28400 Harwich,
North of 12 Mile Rd, between Inkster and Middlebelt | |
| 13 | FARMINGTON HILLS ACTIVITIES CENTER, 28600 Eleven Mile Rd
Between Middlebelt and Inkster | |
| 14 | FIRST PRESBYTERIAN CHURCH, 26165 Farmington Rd
Northwest corner of Eleven Mile Rd | |
| 15 | ST TOMA SYRIAC CATHOLIC CHURCH, 25600 Drake Rd
Corner of Drake and Eleven Mile Rd | |
| 16 | HILLSIDE ELEMENTARY SCHOOL, 36801 Eleven Mile Rd
Between Drake and Halsted | |
| 17 | ST TOMA SYRIAC CATHOLIC CHURCH, 25600 Drake Rd
Corner of Drake and Eleven Mile Rd | |
| 18 | EAST MIDDLE SCHOOL, 25000 Middlebelt
Between 10 & 11 Mile Rds | |
| 19 | EAST MIDDLE SCHOOL, 25000 Middlebelt
Between 10 & 11 Mile Rds | |
| 20 | SALVATION ARMY COMMUNITY CENTER, 27500 Shiawassee
Corner of Shiawassee and Inkster Rds | |
| 21 | LANGAN ELEMENTARY SCHOOL, 23800 Tuck Road
South of 10 Mile Rd, between Orchard Lake and Middlebelt | |
| 22 | BETHLEHEM EVANGELICAL LUTHERAN CHURCH, 35300 Eight Mile Rd
West of Gill Rd | |
| 23 | BETHLEHEM EVANGELICAL LUTHERAN CHURCH, 35300 Eight Mile Rd
West of Gill Rd | |
| 24 | POWER MIDDLE SCHOOL, 34740 Rhonswood
West of Gill Rd | |
| 25 | GILL ELEMENTARY SCHOOL, 21195 Gill Rd
Between 8 & 9 Mile Rds, west of Farmington Rd | |
| 26 | FARMINGTON COMMUNITY SCHOOL, 30415 Shiawassee
Corner of Shiawassee and Tuck Rds | |
| 27 | ST ALEXANDER'S CHURCH, 27835 Shiawassee
Between Middlebelt and Inkster Rds | |

PRECINCT MAP

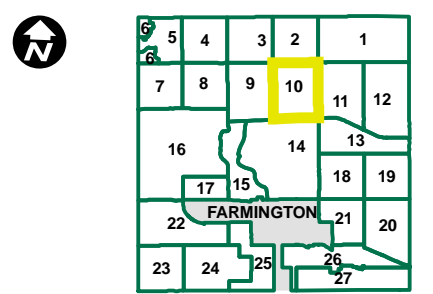

MAP LEGEND

- Voting Location
- Voting Precinct Boundary



DISCLAIMER: Although the information provided by this map is believed to be reliable, its accuracy is not warranted in any way. The City of Farmington Hills assumes no liability for any claims arising from the use of this map.

SOURCES: City of Farmington Hills GIS, 2010
City Clerk's Office, 2010
Oakland County GIS, 2010